

Confidential : All rights reserved ISO 16016. No part of this document may be reproduced, stored in a retrieval system, or transmitted, in any form or by any means, without prior permission. All rights reserved in the event of the granting of a patent or the registration of a utility model or design. Offenders will be held liable for the payment of damages.

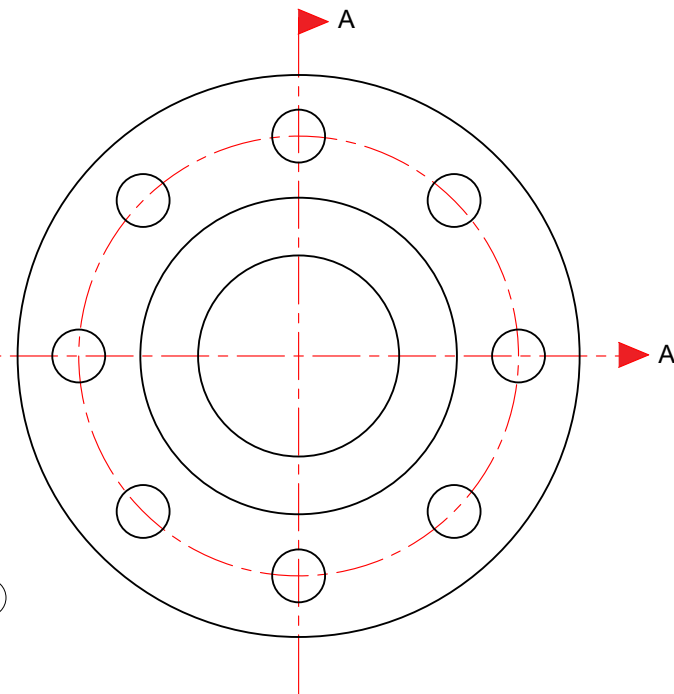
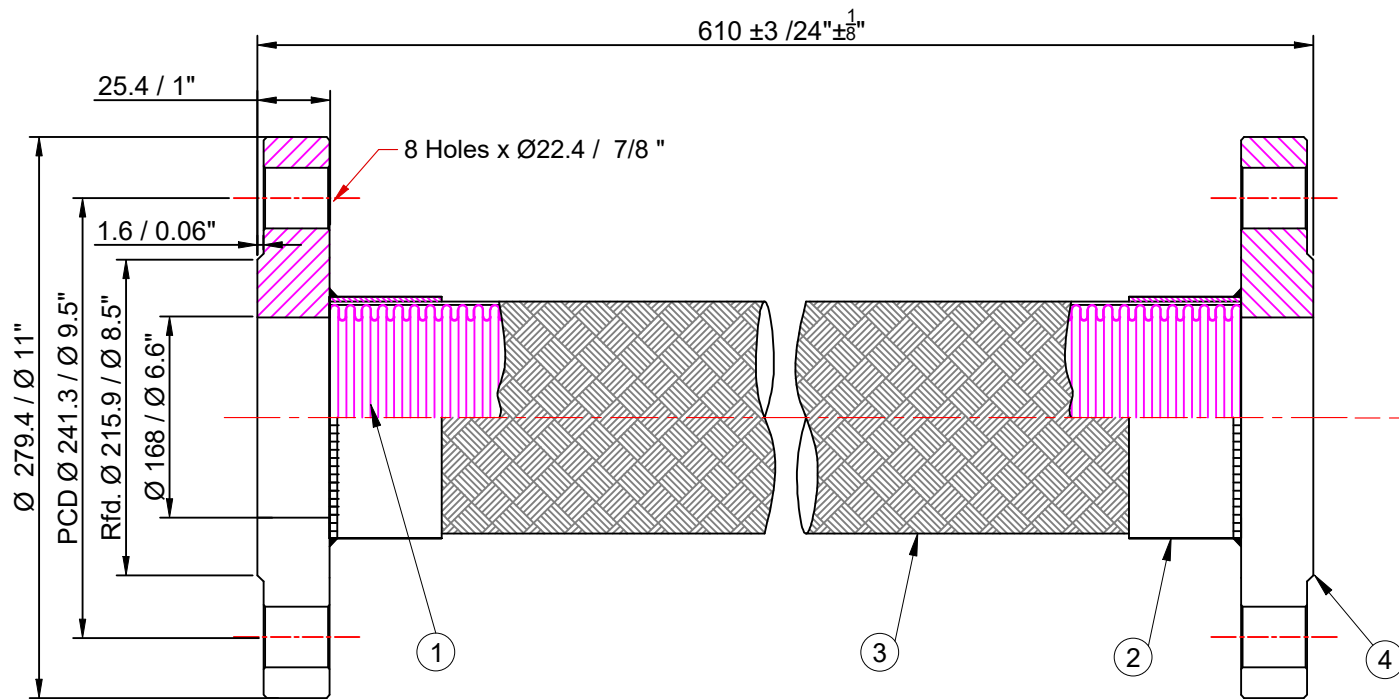

SECTION A-A

*All dimensions are in mm.
unless specified.

Size:(DN)	150 NB	6"
Design Pressure :	16 bar(g)	232 PSI(g)
Design Temperature :	23°C	73.4°F
Test Pressure:	24 bar(g)	348 PSI(g)
Minimum Centerline Bend Radius		
Static:	380 mm	15"
Dynamic:	815 mm	32"

Notes :

1. All surface will be smooth finish, free from welding burrs and Sharp edges.
2. The Burst pressure is 4 times the Design Pressure.

Testing :

1. 100% Die penetration test on weld joints where ever applicabale.
2. Raw material check test for chemical composition and mechanical properties.
3. Dimension and visual check.

Space for Client Approval

Seal & Signature

4	Flange (ANSI B16.5 #150 SORF)	SS 304	2
3	Double Braiding	SS 304	1
2	Neck ring	SS 304	2
1	Corrugation	A 240 Gr. 304	1
Sl.No.	Description	Material	Pcs

Bill of Material

Title:- Flexible Metallic Pump Connector with Both Side Fixed Flange

DRAWN BY	-
CHECKED BY	-
APPROVED BY	-
SCALE: NTS	
DRAWING No.	-
DATE	REV:- 00

OWNER :
Easyflex /VibraSystems

No	Revision Description	Date
----	----------------------	------