

Confidential : All rights reserved ISO 16016. No part of this document may be reproduced, stored in a retrieval system, or transmitted, in any form or by any means, without prior permission. All rights reserved in the event of the granting of a patent or the registration of a utility model or design. Offenders will be held liable for the payment of damages.

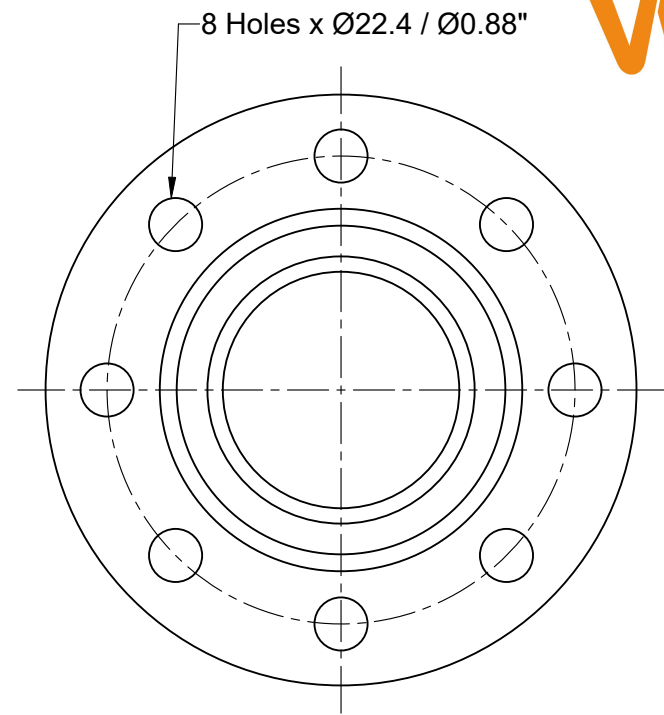

Design Code:	FSA USA Standard			
Size:(DN)	125	5 "		
Pressure Rating :	20 bar(g)	290 PSI(g)		
Max. Temperature :	115°C	239°F		
Test Pressure:	30 bar(g)	435 PSI(g)		
Movement Capacity:	(+)		(-)	
	(mm)	(Inch)	(mm)	(Inch)
Axial Movement:	35	1.375"	50.8	2"
Lateral Movement:	39.7	1.56"	39.7	1.56"
Angular Movement:	30°	30°	30°	30°

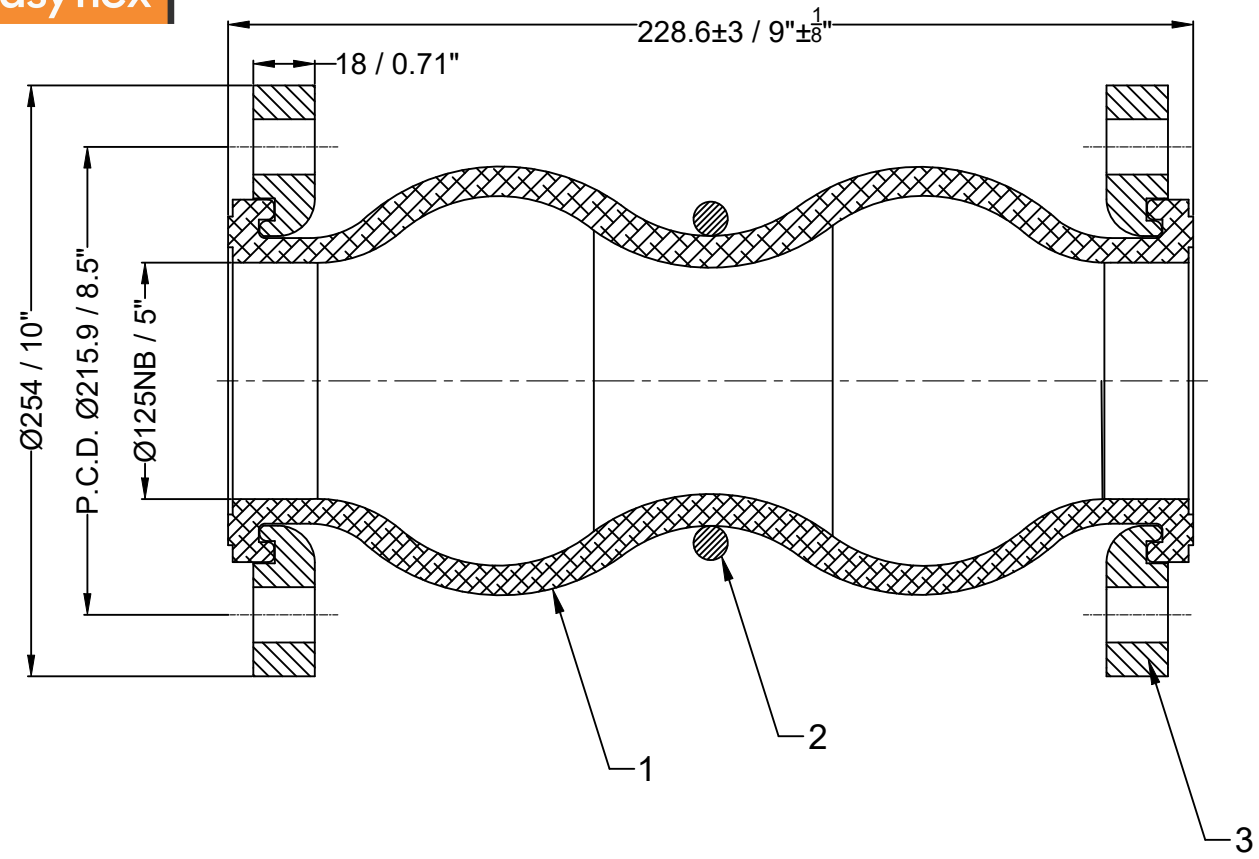
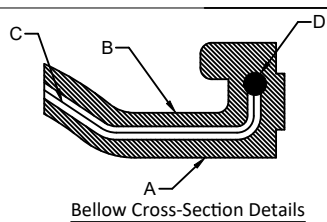

A.	Inner Cover EPDM
B.	Outer Cover EPDM
C.	Reinforce nylon cord fabric
D.	Hard steel wire

3	Flange	IS 2062 Gr.B (Hot Dip Galvanized)	2
2	Ring	SS 304	1
1	Bellow	EPDM	1
Sl.No.	Description	Material	Pcs

Bill of Material

Title:-EPDM Twin Sphere Floating Flange Rubber Expansion Joint with IS 2062 Gr.B Floating Flanges

Client Name:-

DRAWN BY  
CHECKED BY  
APPROVED BY

OWNER :  
Easyflex / VibraSystems

SCALE: NTS

DRAWING No.

DATE

REV:- 00

Notes :  
1. Bellow Tolerance will be as per FSA USA Standard.  
2. Flange drill dimension will be as per ANSI B16.5#150.  
3. Matching flange should be of flat face .  
Testing :  
1. Raw material check test for chemical composition and mechanical properties.  
2. Dimension and visual check.

Seal & Signature		
No	Revision Description	Date