



Application: Support designed to facilitate axial movement of mounted piping caused by thermal expansion / contraction or mechanical shifting. Usage of Roller Hangers is recommended for installations with long horizontal pipe involving changes in the temperature of the fluid medium or external environment. If pipe are gripped rigidly in such cases, forces arising from expansion / contraction can cause piping failure or structural damage.

Features

- Easyflex Rollers are made from solid steel shaft, for higher load bearing capacity and smoother operation than the hollow cast iron rollers supplied by others manufacturers.
- Supplied fully galvanized as standard.

Material

Roller, Roller Pin, Chair "Steel".

Finish

Electro galvanized post manufacture.

Other Options

Epoxy Powder Coated finish (Suffix 'PC')

Hot Dip Galvanized finish (Suffix 'HDG')

Stainless Steel construction (Suffix 'SS')

Compliance - US Standards MSS-SP58 (Type 44), MSS-SP69; BS 3974: Part 1 (1974) EG to ASTM B633 SC3, BS1706 FE/ZN12

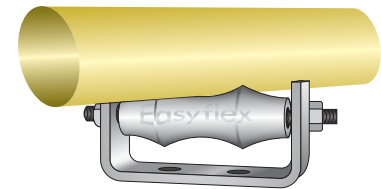
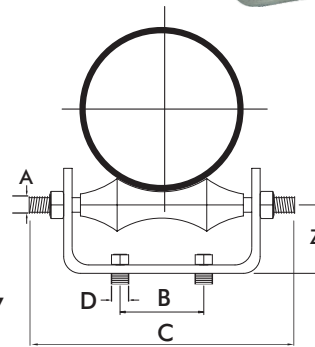

Model No.	Size	Dimensions (inches)					Bracket Size	Z	Max. Recom. Load Lbs
		A	B	C	D				
EFROC060	2"	0.47	1.38	4.33	0.47	0.24 x 1.26	1.57	770	
EFROC075	2 1/2"	0.47	1.38	4.33	0.47	0.24 x 1.26	1.57	770	
EFROC090	3"	0.47	1.97	5.71	0.47	0.24 x 1.26	1.77	770	
EFROC100	3 1/2"	0.47	1.97	5.71	0.47	0.24 x 1.26	1.77	1100	
EFROC115	4"	0.47	1.97	7.09	0.63	0.31 x 1.57	1.97	1100	
EFROC140	5"	0.47	2.95	8.46	0.63	0.31 x 1.57	2.17	1100	
EFROC168	6"	0.75	3.15	9.84	0.63	0.39 x 1.97	2.36	1100	
EFROC220	8"	0.87	3.35	11.22	0.75	0.39 x 1.97	2.95	2640	
EFROC273	10"	0.87	5.12	13.58	0.75	0.47 x 1.97	3.54	2640	
EFROC323	12"	0.98	5.51	15.55	0.75	0.47 x 1.97	4.13	3300	
EFROC355	14"	0.98	6.50	17.32	0.98	0.47 x 1.97	4.72	3300	
EFROC406	16"	1.26	8.27	18.90	0.98	0.47 x 2.95	5.51	7700	
EFROC457	18"	1.26	9.25	20.67	0.98	0.47 x 2.95	6.10	7700	
EFROC508	20"	1.97	10.24	21.85	0.98	0.47 x 2.95	6.50	7700	
EFROC610	24"	1.97	12.20	26.18	0.98	0.63 x 3.94	7.87	12100	

- Due to policy of continual improvement, the specifications are subject to change without prior notice.
- Measurements are subject to 5% tolerance.