

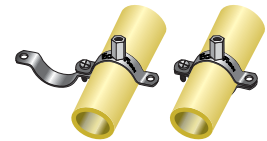

Split-ring type pipe clamps with integral fixing nuts. Suitable for ceiling suspension or vertical wall mounting of piping. Designed with a number of features to enhance product performance and reliability.

Features

- Both halves of the clamp are ribbed, for greater strength.
- Long thread engagement - All Easyflex EFPSC series split clamps are designed with extended thread lengths on the lips of the upper half. This ensures safer installation than clamps offered by others, that have barely one thread engagement also prevents loosening of the clamp's grip over a period of time due the minor vibration that is generally present in piping systems and causes thread wear.
- Twin-thread Nuts - Clamps for pipe ODs 2.76" to 4.84" have M8+M10 twin-thread suspension nuts (as shown), for flexibility.
- Side bolts have a slotted-cross head for convenience.
- Custom designed stainless steel (SS 304 / 316) split clamps are available on request.

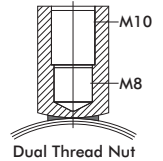

Material : Steel

Finish : Electro galvanized post manufacture.

Other Options : Epoxy Powder Coated finish (Suffix 'PC')
Hot Dip Galvanised finish (Suffix 'HDG')

**Compliance - EG to ASTM B633 SC3
BS 1706 FE/ZN 12**

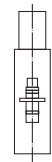
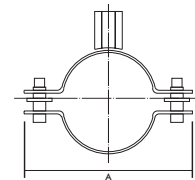

Model No.	Size (inches)	Dia (inches)	Range (inches)	Dimension (inches) A	Thick. (inches)	Break Load Lbs	Safe Load Lbs
EFPSC018	3/8"	0.6	0.59 - 0.75	2.3	0.08	1320	440
EFPSC022	1/2"	0.9	0.79 - 0.98	2.6	0.08	1320	440
EFPSC028	3/4"	1.1	1.02 - 1.18	2.8	0.08	1320	440
EFPSC035	1"	1.4	1.26 - 1.42	3.1	0.08	1320	440
EFPSC040	1 1/4"	1.7	1.50 - 1.69	3.4	0.08	1320	440
EFPSC048	1 1/2"	1.9	1.85 - 2.01	3.6	0.08	1320	440
EFPSC054		2.1	2.09 - 2.28	3.9	0.08	1320	440
EFPSC060	2"	2.4	2.36 - 2.52	4.1	0.08	1320	440
EFPSC063		2.5	2.48 - 2.60	4.3	0.08	1320	440
EFPSC070		2.8	2.68 - 2.83	4.5	0.08	1320	440
EFPSC075	2 1/2"	3.0	2.91 - 3.15	4.7	0.08	1320	440
EFPSC083		3.3	3.19 - 3.39	5.0	0.08	1320	440
EFPSC090	3"	3.5	3.43 - 3.62	5.3	0.08	1320	440
EFPSC100	3 1/2"	3.9	3.90 - 4.13	5.7	0.08	1320	440
EFPSC110		4.3	4.21 - 4.41	6.5	0.08	1320	440
EFPSC115	4"	4.5	4.45 - 4.65	6.3	0.08	1320	440
EFPSC125		4.9	4.92 - 5.12	6.7	0.08	1320	440
EFPSC133		5.2	5.16 - 5.39	7.0	0.08	1320	440
EFPSC140	5"	5.5	5.43 - 5.59	7.2	0.10	1980	660
EFPSC150		5.9	5.83 - 6.02	7.6	0.10	1980	660
EFPSC160		6.3	6.26 - 6.54	8.0	0.10	1980	660
EFPSC168	6"	6.6	6.61 - 6.77	8.3	0.10	1980	660
EFPSC200	8"	7.9	7.87 - 8.35	9.6	0.10	1980	660



Ordering

- For insulated pipe, please select model based on effective OD or State pipe size and insulation thickness in the order.
- Where Easyflex Rubber Support Inserts (RSI) are used, specifying 'matching EFSSC Clamps' will suffice.
- In the case of plain pipe, for any type of piping other than steel, please select EFPSC model based on the actual outer pipe diameter. Selecting on the basis of nominal sizes for these pipes can result in errors on account of the large number of schedules prevalent.

Model No.	Steel (Sch 40)		UPVC / PE	ABS
	Inches	mm		
EFPSCC018				16
EFPSCC022	1/2"	22	20	DN15 (21.4)
EFPSCC028	3/4"	28	25	DN20 (26.8)
EFPSCC035	1"	35	32, 38	DN25 (33.6)
EFPSCC040	1 1/4"	42	40, 43	DN32 (42.3)
EFPSCC048	1 1/2"	48	45	DN40 (48.3)
EFPSCC054			54	
EFPSCC060	2"	60	60	DN50 (60.4)
EFPSCC063				
EFPSCC070			70	
EFPSCC075	2 1/2"	75	75	DN65 (75.4)
EFPSCC083			83	
EFPSCC090	3"	90	90	
EFPSCC100			102	DN80 (88.9)
EFPSCC110			110	
EFPSCC115	4"	115	115	DN100 (114.3)
EFPSCC125			125	
EFPSCC133			135	
EFPSCC140	5"	140	140	DN125 (140.2)
EFPSCC150			152	
EFPSCC160			160	
EFPSCC168	6"		168	DN150 (168.3)
EFPSCC200			200	
EFPSCC220	8"	219	220, 225	DN200 (225.0)
EFPSCC250			250	DN225 (250.4)
EFPSCC315				DN300 (315.5)

- Due to policy of continual improvement, the specifications are subject to change without prior notice.
- Measurements are subject to 5% tolerance.
- To achieve good sound suppression do not over load fitting.